

e.lift 1500/2200 lbs NEO

I TEMPORARY PERSONNEL LIFTING I ELECTRIC WIRE ROPE HOIST

e.lift 1500 and e.lift 2200 lbs are versatile personnel lifting hoists for use with suspended platforms, cradles, elevator cabin car or False Car.

Load capacity of 1500 lbs (680 kg) or 2200 lbs (1000 kg)
Single or three-phase, run on 208V power.



VERSATILITY

- ✓ Unlimited working height
- ✓ One or three-phase supply



SAFETY

- ✓ Electronic overload (N.E.O System®):
 - Indicates load in real time
 - Obstacle switch during descent to prevent accidents
- ✓ Securichute™ overspeed fall arrest device on suspension wire rope
- ✓ Securistop™ anti-tilt fall arrest device on secondary wire rope (optional)
- ✓ Limit switch plate and sensor stop the hoist at a top position (optional)



COMFORT

- ✓ Hour meter (N.E.O System®)
- ✓ Voltage indicator
- ✓ Compact & light - Aluminium casing
- ✓ Carrying handle
- ✓ Pendant control
- ✓ Wheels (optional)
- ✓ Rope guide or Exit roller (optional)

Electronic overload (NEO SYSTEM®)



Emergency stop



UP/DOWN control switch

Voltage indicator

Overspeed fall arrest device (Securichute™)

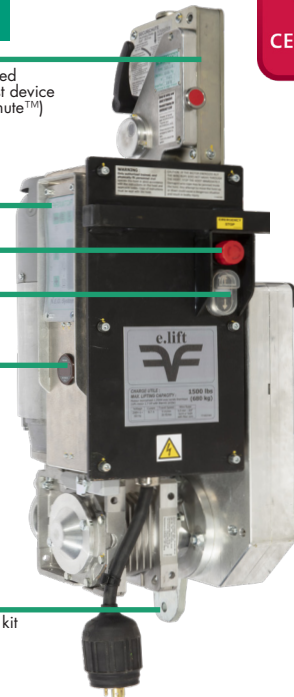
Platform mounting kit



Technical Features	e.lift 1500 3~ 527 C	e.lift 1500 1~ 527 L	e.lift 2200 3~ 527 A
Load Capacity	1500 lbs (680 kg)		2200 lbs (1000 kg)
Operating Speed	30 ft/min (9m/min)		
Weight	160 lbs (73 kg)	156 lbs (71 kg)	160 lbs (73 kg)
Voltage & Tension	208V / 3~ / 60 Hz	208V / 1~ / 60 Hz	208V / 3~ / 60 Hz
Motor Power	2.5 HP / 1.85kW	1.7 HP / 1.25 kW	2.5 HP / 1.85 kW
Dimensions	31.1" x 16.1" x 11.5" (789x408x291 mm)		
Wire rope diameter	3/8" (9,5mm) - 5x19 or 5x26, preformed galvanized finish.		
Temperature for use	14°F/131°F (-10°C/+55°C)		
Overload	Yes: N.E.O SYSTEM panel with adjustable settings		
Standard (Coverage)	UL1323, CSA Z271-20 (USA/CAN)		UL1323 (USA)
	 		

e.lift 1500/2200 lbs NEO

I TEMPORARY PERSONNEL LIFTING | ELECTRIC WIRE ROPE HOIST

STANDARD EQUIPMENT

1. Overspeed fall arrest device (Securichute™) on suspension wire rope
2. Lever for controlled descent
3. Carrying handle
4. NEO System® electronic overload
5. Voltage indicator
6. Stirrup bar
7. UP/DOWN control switch
8. Emergency stop
9. Pendant control

ADDITIONAL OPTIONS

1. Slack-rope anti-fall device (Securistop™) on safety wire rope with rope guide included
2. Top limit switch plate and sensor
3. Wheels
4. Rope guide on primary cable
5. Hook mounting kit (not to be used with Securistop™)

FOCUS ON:

NEO System® electronic overload

- Real time load indicator
- Overload and lower limit switch
- Hour counter

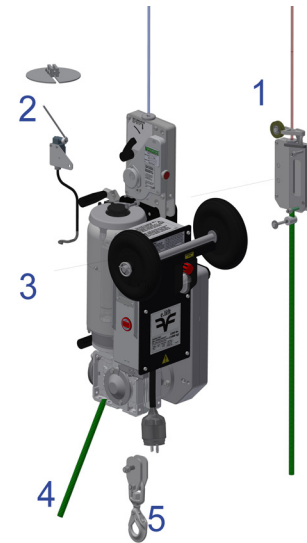
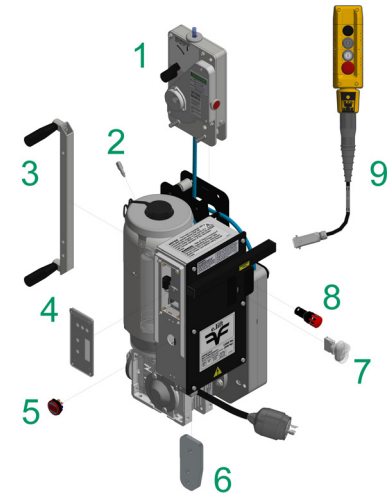

FOCUS ON: Securistop™ fall arrest device

Stops the hoist if:

- Slack wire rope detection
- Platform angle > 14°

