

# E.LIFT 1000 LBS

I TEMPORARY PERSONNEL LIFTING | ELECTRIC WIRE ROPE HOIST

e.lift 1000 lbs is a versatile personnel lifting hoist for use with temporary and permanent suspended platforms.

Load capacity of 1000 lbs (approx. 450 kg)  
Single-phase, run on 208V power at 60Hz.



Overspeed fall arrest device  
(Securichute™)

Emergency stop

Overload indicator

UP/DOWN  
control switch

Voltage indicator



## EASY MAINTENANCE

- ✓ Plug and play replacement of electric panel
- ✓ Wear belt prevents cable damage
- ✓ Easy access to mechanical parts





## SAFETY

- ✓ Securichute™ overspeed fall arrest device on suspension wire rope
- ✓ Securistop™ fall arrest device for slack wire rope detection on secondary wire rope (optional)
- ✓ Mechanical overload (optional)
- ✓ Limit switches stop the hoist at a top position (optional)



## COMFORT

- ✓ Aluminum casing
- ✓ Compact & light
- ✓ Overload indicator
- ✓ Voltage indicator
- ✓ Controlled descent lever
- ✓ Pendant control (optional)
- ✓ Rope guide prevents damage to the wire rope (optional)
- ✓ Exit roller (optional)
- ✓ Carry handle or wheels (optional)
- ✓ Hook mounting kit (optional)\* \*not compatible with Securistop
- ✓ Wire rope winder (optional)
- ✓ Control box for 2+ hoists (optional)
- ✓ Storage box 120l (optional)

Technical Features	e.lift 1000 lbs 1~ 526 K
Load Capacity	1000 lbs (approx. 450 kg)
Operating Speed	30 ft/min (9 m/min)
Weight	108 lbs (49 kg)
Voltage & Tension	208V / 1~ / 60Hz
Motor Power	1.2 HP / 0.88 kW
Dimensions	31.6"x14.5"x11.5" (804x370x292 mm)
Wire rope diameter	Ø 5/16" (8.3mm), 5x19 or 5x26, preformed galvanized finish.
Temperature for use	14°F / 131° F (-10° C / +55° C)
Standard (Coverage)	UL 1323 CSA Z271 (USA/CAN)  
Overload (optional)	Yes, adjustable mechanical load limiter

# E.LIFT 1000 LBS

I TEMPORARY PERSONNEL LIFTING | ELECTRIC WIRE ROPE HOIST

## STANDARD EQUIPMENT

1. Overspeed fall arrest device (Securichute™) on primary wire rope
2. Lever for controlled descent
3. Emergency stop
4. Overload indicator (only with additional option #5 below)
5. UP/DOWN control switch
6. Main hoist handle
7. Small hoist handle
8. Temporary platform mounting kit - Stirrup bar
9. Exit roller
10. Voltage indicator

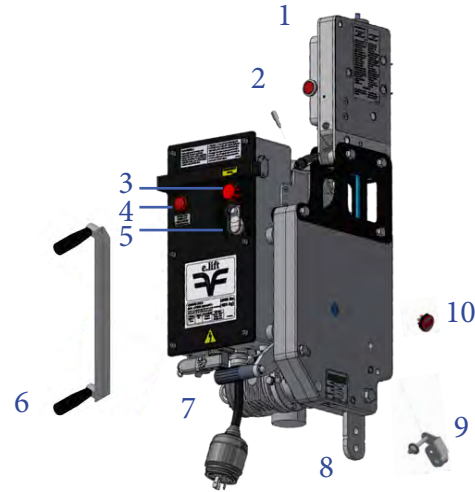

## ADDITIONAL OPTIONS

1. Slack-rope device (Securistop™) on secondary wire rope
2. Top limit switch plate and sensor
3. Exit spring on primary wire rope
4. Hook mounting kit (not to be used with Securistop™)
5. Mechanical overload
6. Wire rope winder
7. Control box with automatic level readjustment (Gyrostop)
8. Pendant control
9. Storage box 120l

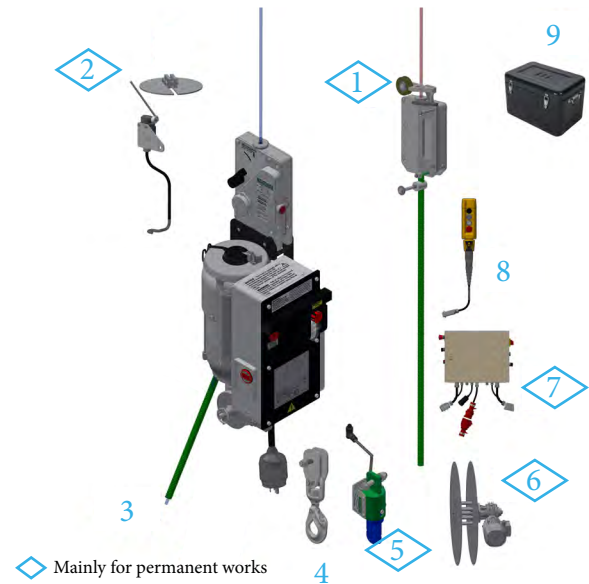

◇ Mainly for permanent works

## FOCUS: *Securistop™ slack-rope device*

### *Stops the hoist in case of:*

- Slack wire rope
- Platform angle > 14°

